

Part Reference	Description
	Tropical Cyclone (Ground Fix)

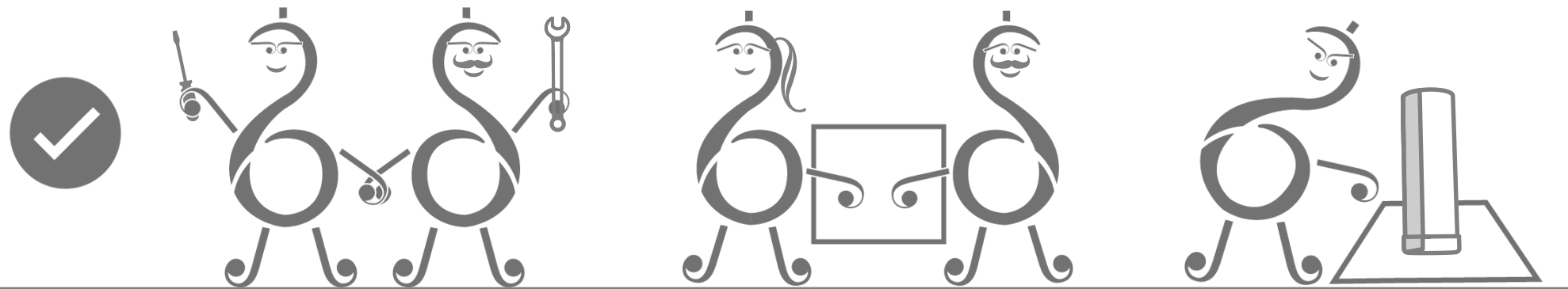

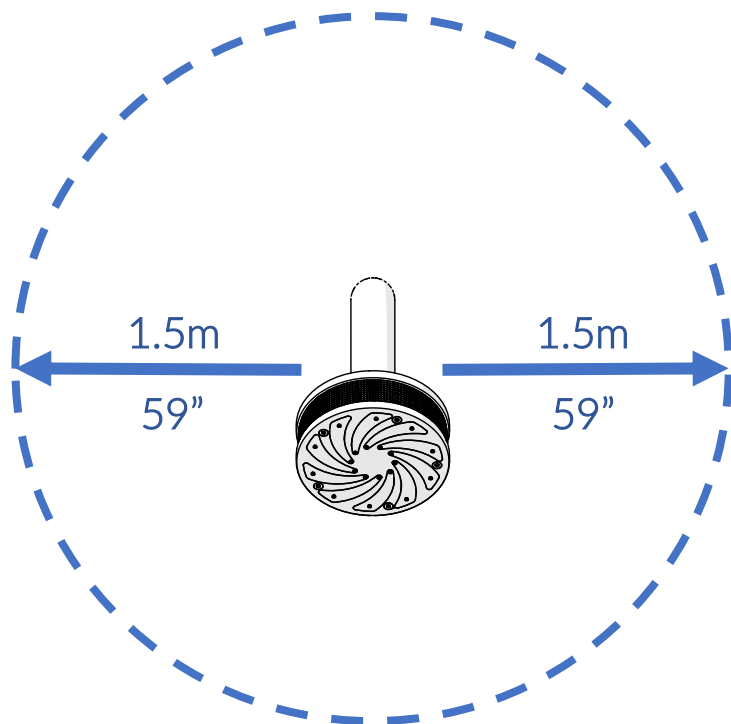



Check Risk Assessment

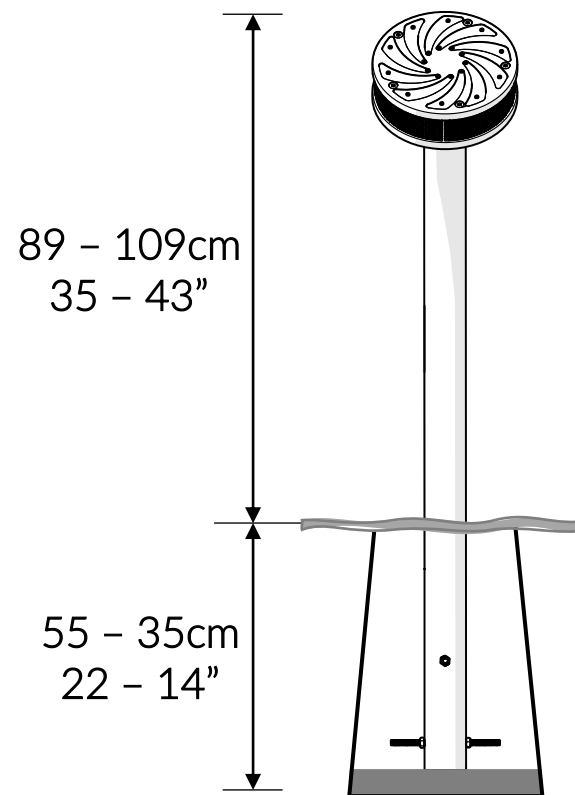

Packages

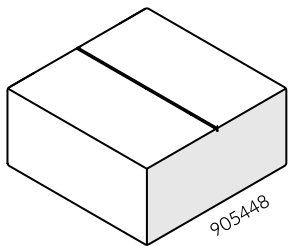

x1

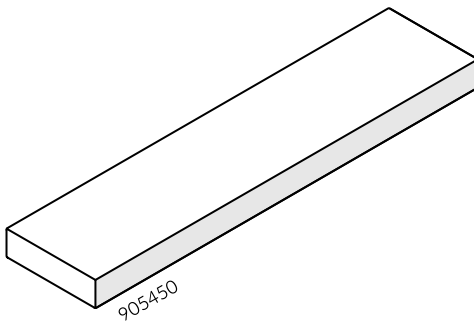

x1

		L	W	H	Weight	Net
x1	905448	27cm / 11"	27cm / 11"	13cm / 5"	3.5kg / 8lbs	
x1	905450	128cm / 50"	30cm / 12"	8cm / 3"	3.5kg / 8lbs	

Tools required (not supplied)

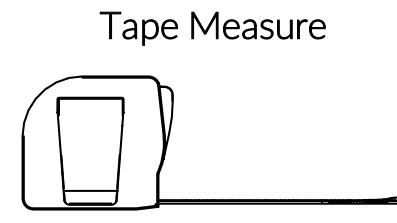
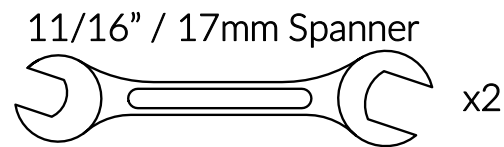

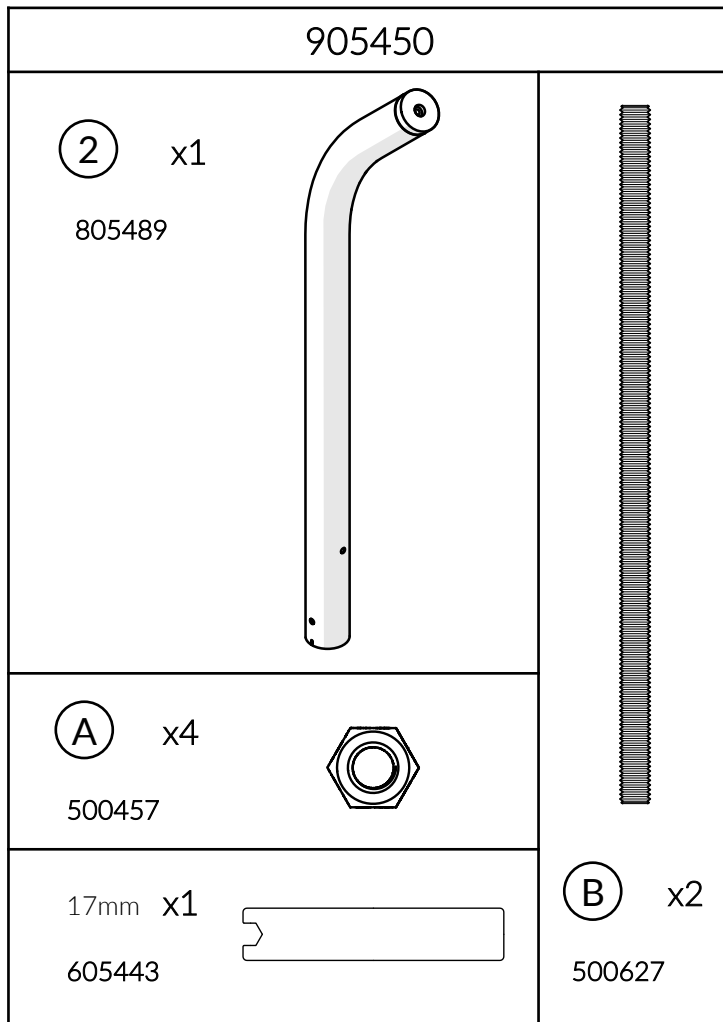
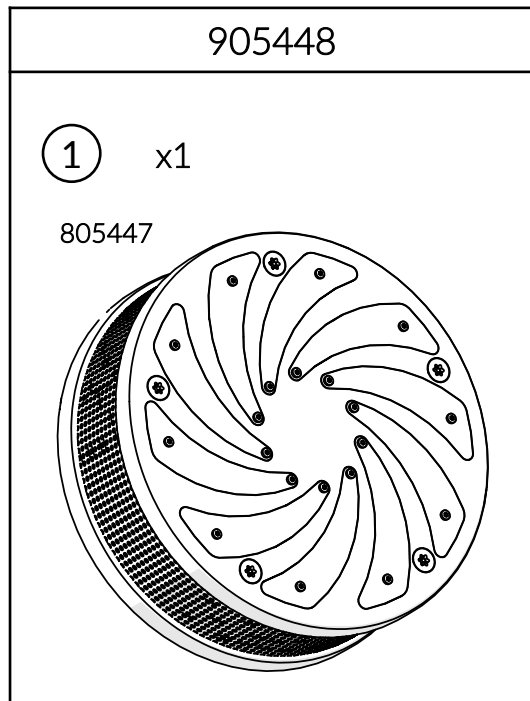

1.

1.1

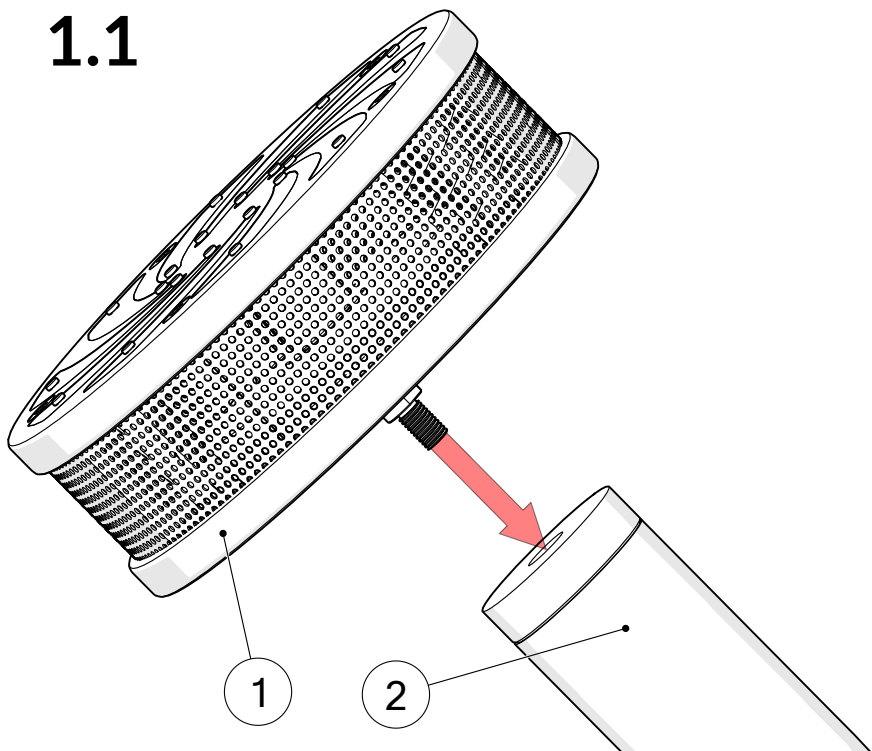

1.2

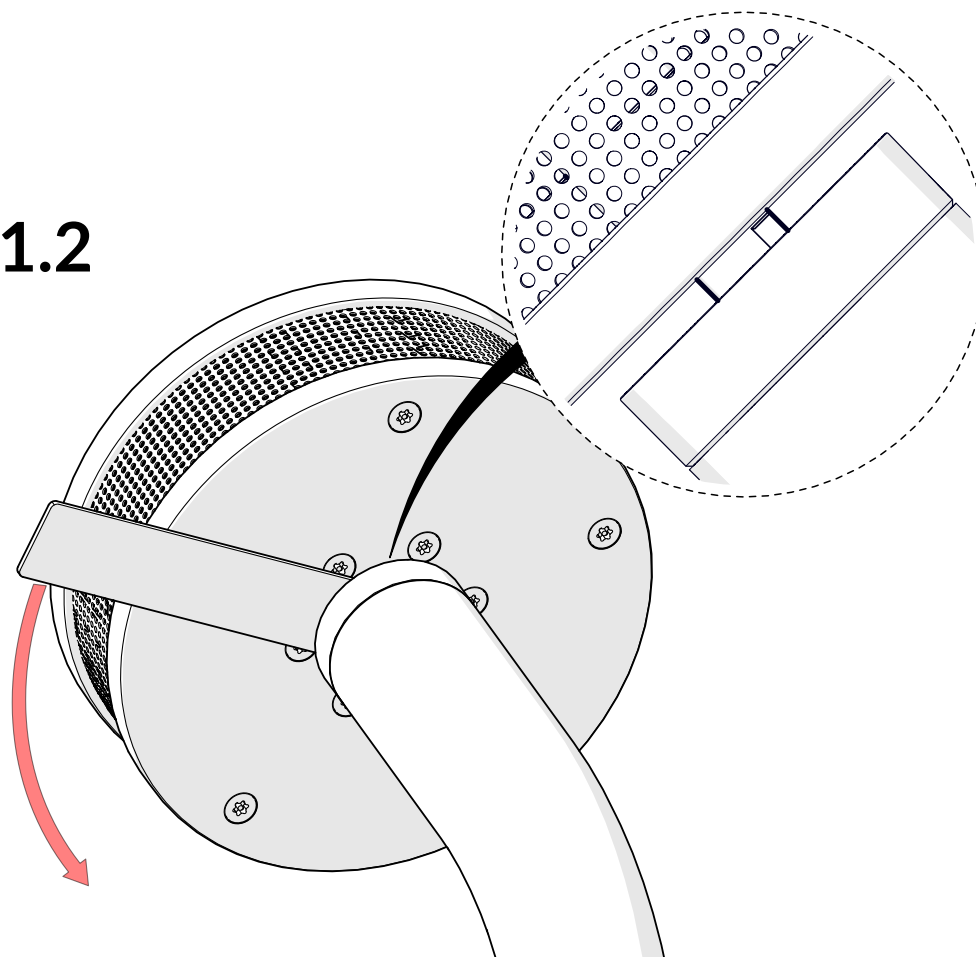

17mm

2.

2.1

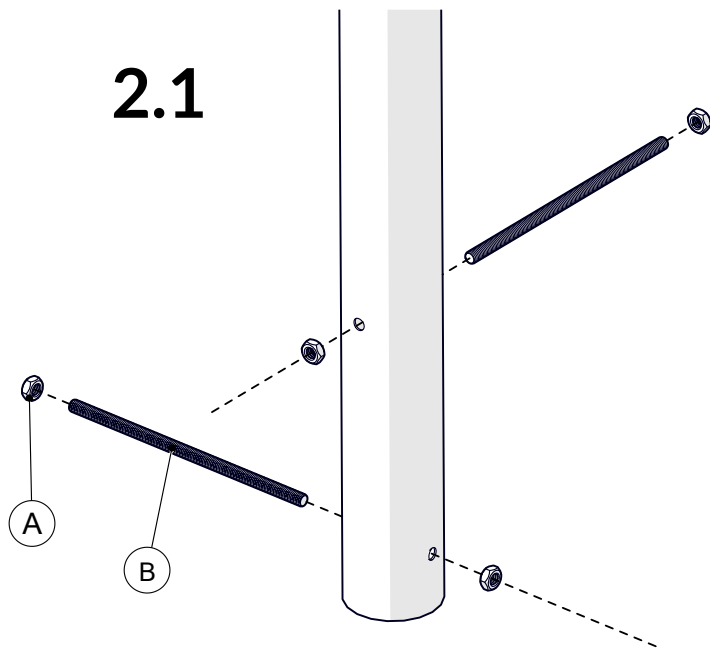

2.2

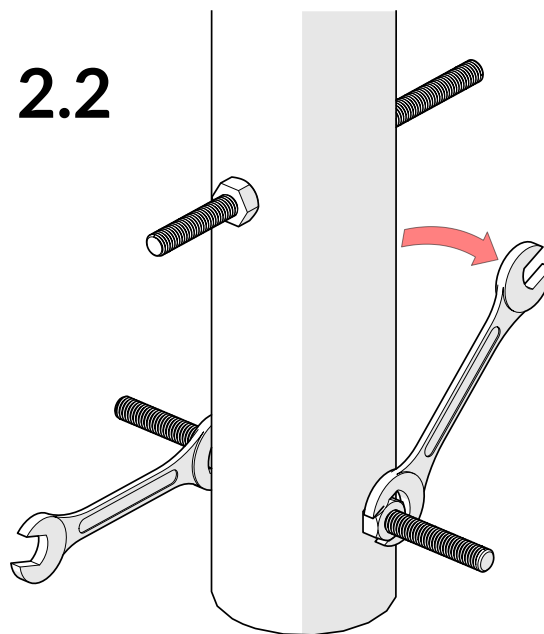

2.3

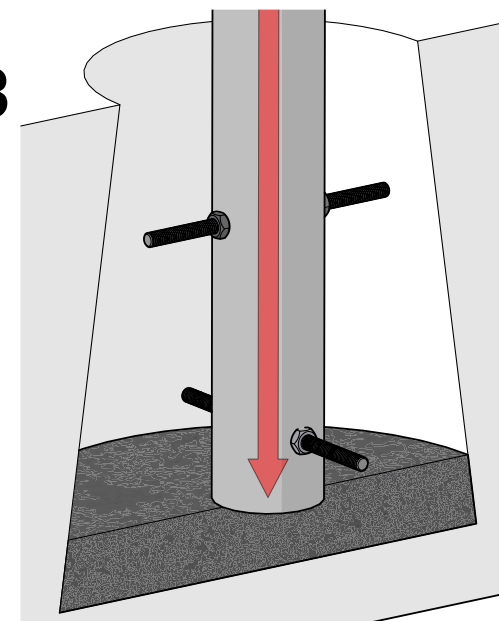

A		x4
B		x2

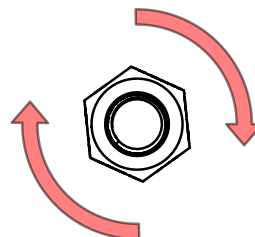

3.



Foundations should not present a hazard

Refer to your local Health & Safety standards

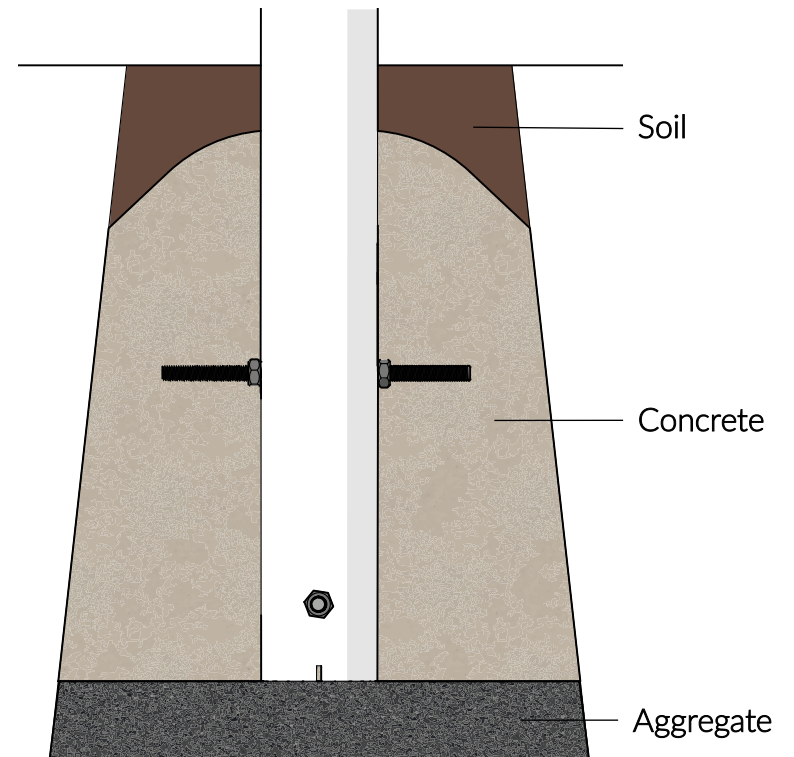
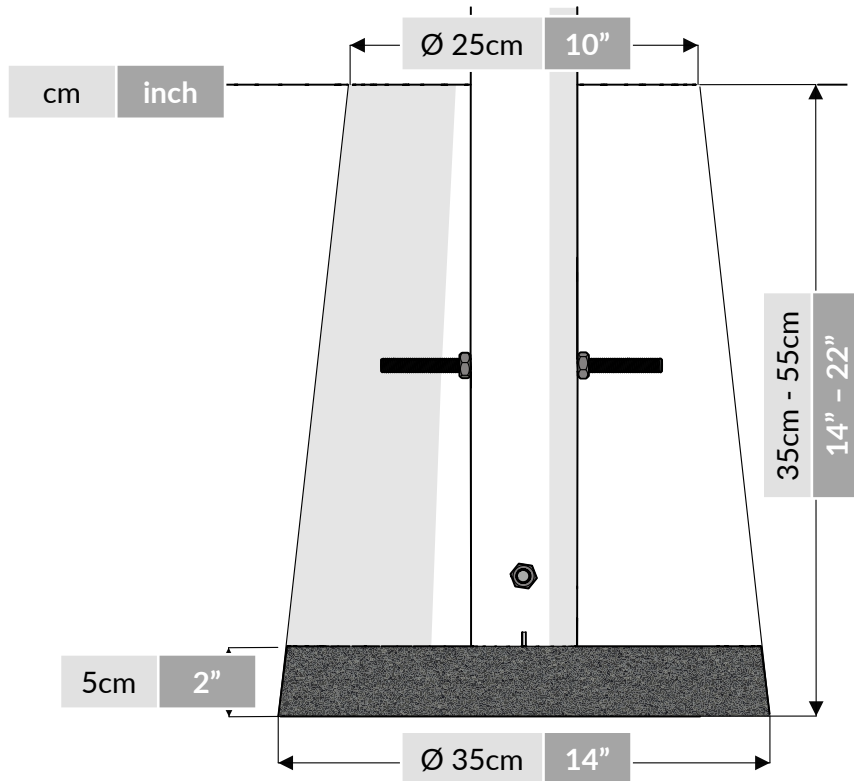
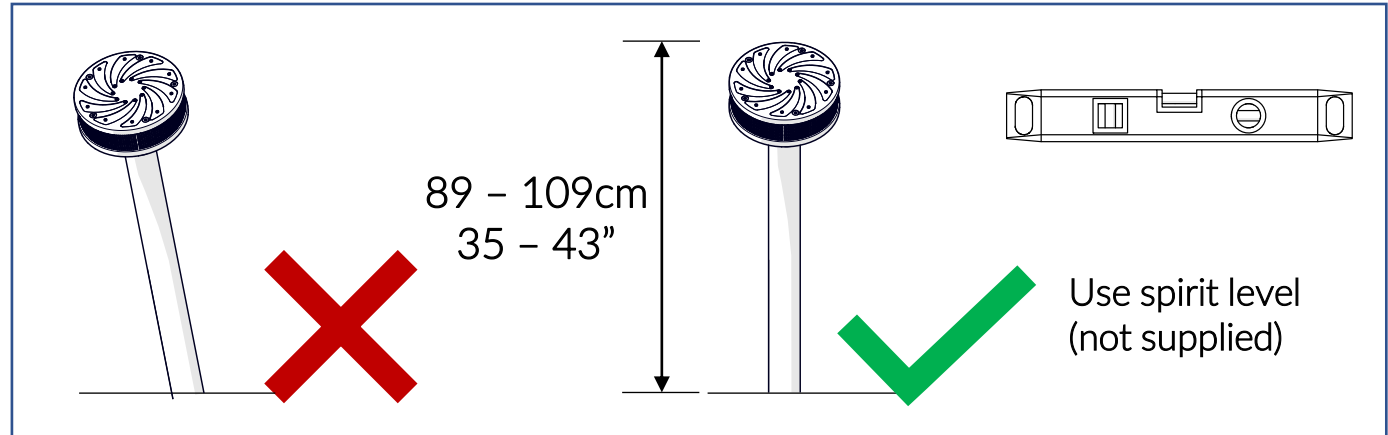

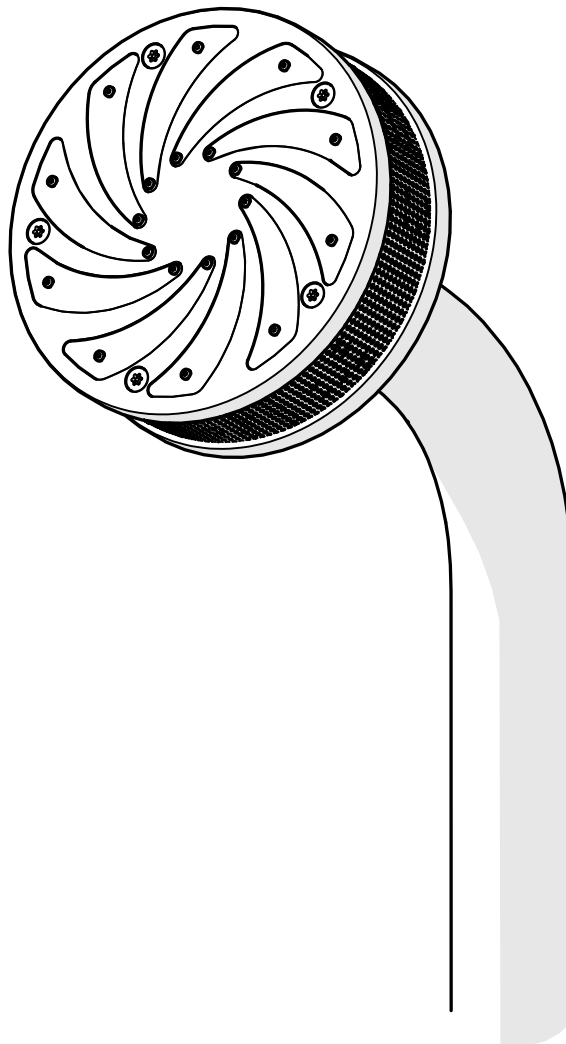

percussionplay.com



info@percussionplay.com



UK
[01730 235 180](tel:01730235180)

USA & CAN
[+1 \(866\) 882 9170](tel:+18668829170)

EUR & ROW
[+44 1730 235 180](tel:+441730235180)